

The Pulsatron Series HV designed for high viscosity applications for precise and accurate metering control. The Series HV offers manual control over stroke length and stroke rate as standard with the option to choose between 4-20mA and external pace inputs for automatic control.

Five distinct models are available, having pressure capabilities to 150 PSIG (10 BAR) @ 12 GPD (1.9 lph), and flow capacities to 240 GPD (37.9 lph) @ 80 PSIG (5.6 BAR), with a turndown ratio of 100:1. Metering performance is reproducible to within $\pm 2\%$ of maximum capacity.

Features

- Automatic Control, available with 4-20mADC direct or external pacing, with stop function.
- Manual Control by on-line adjustable stroke rate and stroke length.
- Auto-Off-Manual switch.
- Highly Reliable timing circuit.
- Circuit Protection against voltage and current upsets.
- Panel Mounted Fuse.
- Solenoid Protection by thermal overload with auto-reset.
- Water Resistant, for outdoor and indoor applications.
- Indicator Lights, panel mounted.
- Guided Ball Check Valve Systems, to reduce back flow and enhance outstanding priming characteristics.
- Viscosities to 20,000 CPS.

Controls



Manual Stroke Rate

- Turn-Down Ratio 10:1

Manual Stroke Length

- Turn-Down Ratio 10:1

4-20mA or 20-4mA Input

- Automatic Control

Operating Benefits

- Reliable metering performance.
- Rated "hot" for continuous duty.
- High viscosity capability.
- Leak-free, sealless, liquid end.



Aftermarket

- KOPkits
- Gauges
- Dampeners
- Pressure Relief Valves
- Tanks
- Pre-Engineered Systems
- Process Controllers (PULSAblue, MicroVision)



PULSAtron® Series HV

Specifications and Model Selection

MODEL		LVB3	LVF4	LVG4	LVG5	LVH7
Capacity nominal (max.)	GPH	0.50	1.00	2.00	4.00	10.00
	GPD	12	24	48	96	240
	LPH	1.9	3.8	7.6	15.1	37.9
Pressure (max.)	PSIG	150	150	110	110	80
	BAR	10	10	7	7	5.6
Connections:	Tubing	(S) .50" I.D. X .75" O.D. .38" I.D. X .50" OD (LVB3 & F4 only) (S & D) .50" I.D. X .75" O.D. (LVG4,G5 & H7 only)				

Engineering Data

Pump Head Materials Available:	GFPPL PVC PVDF 316 SS
Diaphragm:	PTFE-faced CSPE-backed
Check Valves Materials Available:	
Seats/O-Rings:	PTFE CSPE Viton
Balls:	Ceramic PTFE 316 SS Alloy C
Fittings Materials Available:	GFPPL PVC PVDF
Bleed Valve:	Same as fitting and check valve selected, except 316SS
Injection Valve & Foot Valve Assy:	Same as fitting and check valve selected
Tubing:	Clear PVC White PE

Important: Material Code - GFPPL=Glass-filled Polypropylene, PVC=Polyvinyl Chloride, PE=Polyethylene, PVDF=Polyvinylidene Fluoride, CSPE=Generic formulation of Hypalon, a registered trademark of E.I. DuPont Company. Viton is a registered trademark of E.I. DuPont Company. PVC wetted end recommended for sodium hypochlorite.

Engineering Data

Reproducibility:	+/- 2% at maximum capacity
Viscosity Max CPS:	20,000 CPS
Stroke Frequency Max SPM:	125
Stroke Frequency Turn-Down Ratio:	10:1
Stroke Length Turn-Down Ratio:	10:1
Power Input:	115 VAC/50-60 HZ/1 ph 230 VAC/50-60 HZ/1 ph
Average Current Draw:	
@ 115 VAC; Amps:	1.0 Amps
@ 230 VAC; Amps:	0.5 Amps @ 230 VAC
Peak Input Power:	300 Watts
Average Input Power @ Max SPM:	130 Watts

Custom Engineered Designs – Pre-Engineered Systems



Pre-Engineered Systems

Pulsafeeder's Pre-Engineered Systems are designed to provide complete chemical feed solutions for all electronic metering applications. From stand alone simplex pH control applications to full-featured, redundant sodium hypochlorite disinfection metering, these rugged fabricated assemblies offer turn-key simplicity and industrial-grade durability. The UV-stabilized, high-grade HDPE frame offers maximum chemical compatibility and structural rigidity. Each system is factory assembled and hydrostatically tested prior to shipment.

Dimensions

Series HV Dimensions (inches)					
Model No.	A	B	C	D	Shipping Weight
LVB3	5.4	9.3	9.5	7.5	13
LVF4	5.4	10.8	10.8	7.5	18
LVG4	5.4	9.5	10.6	7.5	18
LVG5	5.4	10.8	10.8	7.5	18
LVH7	6.1	11.5	11	8.2	25

NOTE: Inches X 2.54 = cm

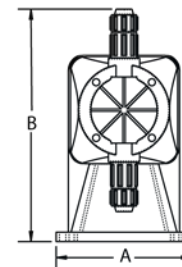
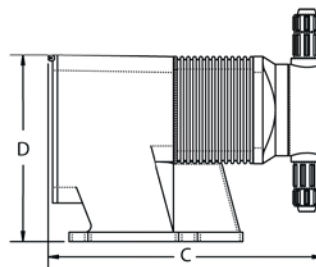

pulsafeeder.com



27101 Airport Rd
Punta Gorda, FL 33982
Phone: ++1(941) 575-3800
Fax: ++1(941) 575-4085

An ISO 9001 and ISO 14001 Certified Company



EMP033 H10